

# Mini HI-FI Component System

GB Operating Instructions

MHC-EC909iP/EC709iP



© 2010 Sony Corporation Printed in China

<http://www.sony.net/>

## Note on DualDiscs

A DualDisc is a two sided disc product which mates DVD recorded material on one side with digital audio material on the other side. However, since the audio material side does not conform to the Compact Disc (CD) standard, playback on this product is not guaranteed.

## Music discs encoded with copyright protection technologies

This product is designed to playback discs that conform to the Compact Disc (CD) standard. Recently, various music discs encoded with copyright protection technologies are marketed by some record companies. Please be aware that among those discs, there are some that do not conform to the CD standard and may not be playable by this product.

## License and Trademark Notice

- iPod is a trademark of Apple Inc., registered in the U.S. and other countries.
- iPhone is a trademark of Apple Inc.
- MPEG Layer-3 audio coding technology and patents licensed from Fraunhofer IIS and Thomson.
- All other trademarks and registered trademarks are of their respective holders. In this manual, ™ and ® marks are not specified.

## MHC-EC909iP

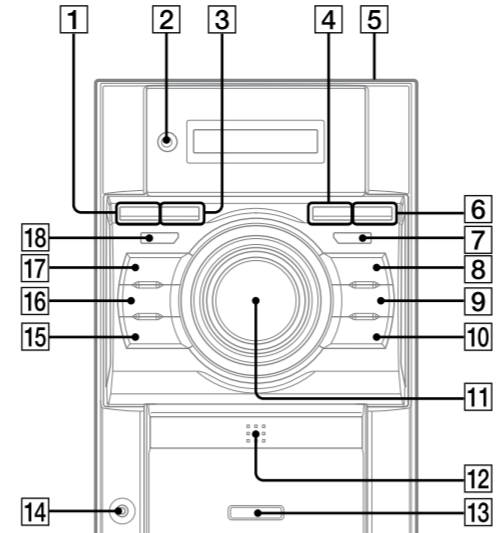

## MHC-EC709iP

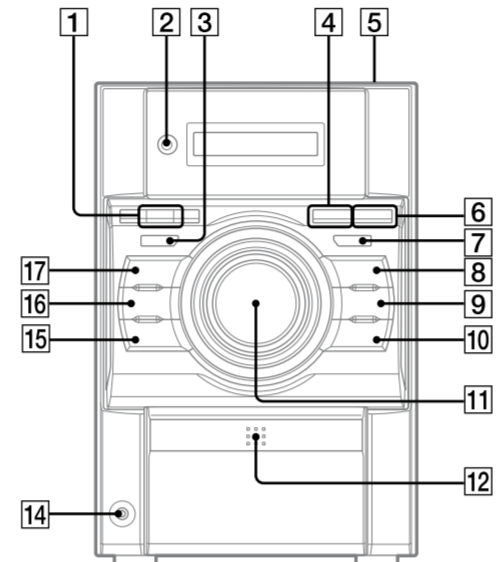

## Remote

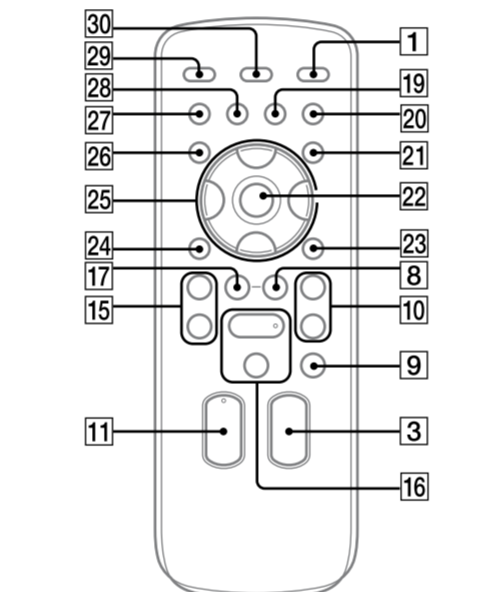

This manual mainly explains operations using the remote, but the same operations can also be performed using the buttons on the unit having the same or similar names.

## To use the remote

Slide and remove the battery compartment lid, and insert the two supplied R6 (size AA) batteries, ● side first, matching the polarities shown below.

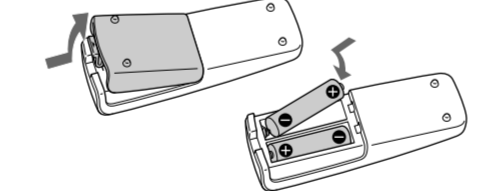

## Notes on using the remote

- With normal use, the batteries should last for about six months.
- Do not mix an old battery with a new one or mix different types of batteries.
- If you do not use the remote for a long period of time, remove the batteries to avoid damage from battery leakage and corrosion.
- Batteries installed devices shall not be exposed to excessive heat such as sunshine, fire or the like.

## Getting Started

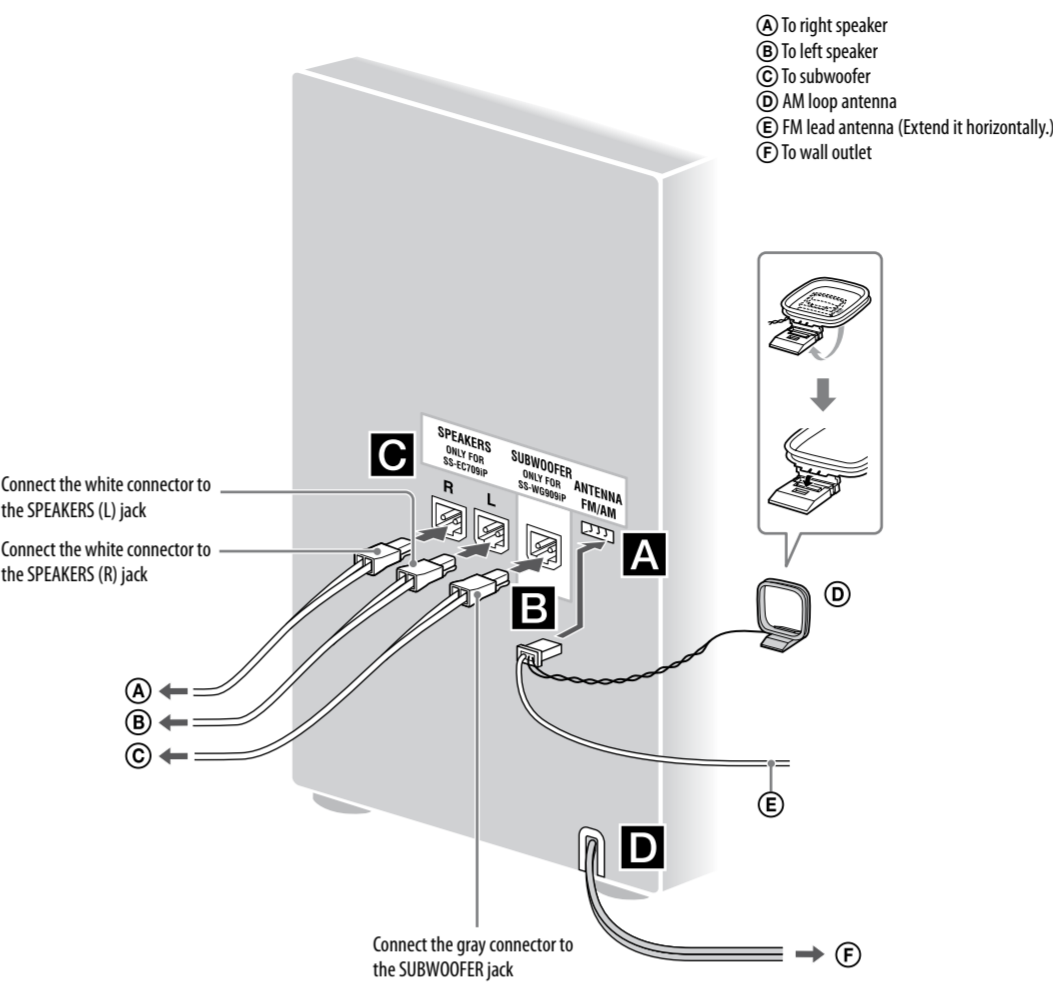

## A Antennas

Find a location and an orientation that provide good reception, and then set up the antenna. Keep the antennas away from the speaker cords and the power cord to avoid picking up noise.

## B Subwoofer (MHC-EC909iP only)

Connect the subwoofer cord to the SUBWOOFER jack. Place the subwoofer vertically to obtain a better bass reproduction. Also, position the subwoofer:
 

- on a solid floor where resonance is unlikely to occur.
- at least a few centimeters away from the wall.
- away from the center of the room or place a bookshelf against a wall, to avoid generating a standing wave.

## Operations

### Playing a CD/MP3 disc

- Select the CD function. Press FUNCTION +/- [3] or FUNCTION [3] on the unit repeatedly (or CD [4] on the unit).
- Place a disc. Press ▲ PUSH OPEN/CLOSE [5] on the unit, and place a disc with the label side up on the CD compartment. To close the CD compartment, press ▲ PUSH OPEN/CLOSE [5] on the unit.

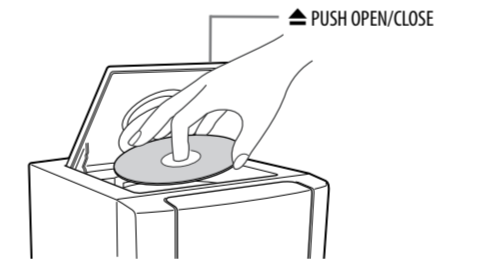

- Start playback. Press ► (play) (or ►|| (play/pause) on the unit) [16].

### Other operations

To	Press
Pause playback	(pause) (or ►   (play/pause) on the unit) [16]. To resume play, press the button again.
Stop playback	■ (stop) [9].
Select a folder on an MP3 disc	□ (select folder) + [8]/- [17] repeatedly.
Select a track or file	◀◀ (go back) [15]/▶▶ (go forward) [10].
Find a point in a track or file	Hold down ◀◀ (rewind) [15]/▶▶ (fast forward) [10] during playback, and release the button at the desired point.
Select Repeat Play	REPEAT [28] repeatedly until "REP" or "REPI" appears.

### To change the play mode

Press PLAY MODE [27] repeatedly while the player is stopped. You can select normal play ("□") for all MP3 files in the folder on the disc, shuffle play ("SHUF" or "□ SHUF"\*) for folder shuffle, or program play ("PGM").

\* When playing a CD-DA (audio) disc, □ (SHUF) Play performs the same operation as normal (SHUF) Play.

**Note on Repeat Play**  
"REPI" indicates that a single track or file is repeated until you stop it.

**Note on shuffle play mode**  
When you turn off the system, the selected shuffle play mode ("SHUF" or "□ SHUF") is cleared and the play mode returns to normal play mode ("□").

- Notes on playing MP3 discs
  - Do not save other types of tracks or files, or unnecessary folders on a disc that has MP3 files.
  - Folders that have no MP3 files are skipped.
  - MP3 files are played back in the order that they are recorded onto the disc.
  - The system can only play MP3 files that have a file extension of ".mp3".
  - Even when file name has the ".mp3" file extension, if the actual file differs, playing this file may generate a loud noise which could damage the speaker system and the system may malfunction.
  - The maximum number of:
    - folders is 255 (including the root folder).
    - MP3 files is 512.
    - folder levels (the tree structure of files) is 8.
  - Compatibility with all MP3 encoding/writing soft ware, recording device, and recording media cannot be guaranteed. Incompatible MP3 discs may produce noise or interrupted audio or may not play at all.

### Notes on playing multisession discs

- If the first session on the disc is a CD-DA session, the other sessions on the disc cannot be recognized regardless of the session format; only CD-DA tracks in the first session can be played back.
- If the session format for the first session is CD-ROM and the following sessions are recorded in the same format, the system will continue to play back MP3 files accordingly in multiple sessions until the system encounters another session recorded in a different format.

## C Speakers

Connect the speaker cords to the SPEAKERS jacks.

## D Power

Connect the power cord to a wall outlet. If the plug does not fit the wall outlet, detach the supplied plug adaptor (only for models equipped with an adaptor).

## To attach the speaker pads

Attach the supplied speaker pads to the bottom of the front speakers and subwoofer to prevent slipping.

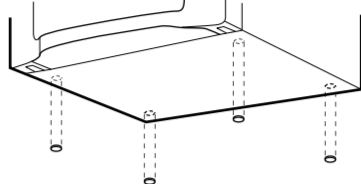

## To use the iPod/iPhone

Make sure the iPod indicator [13] lights up (MHC-EC909iP only). Press PUSH [12] on the unit to flip-open the Dock, slide the LOCK lever to the HOLD position, and insert a Dock Adapter into the Dock before use.

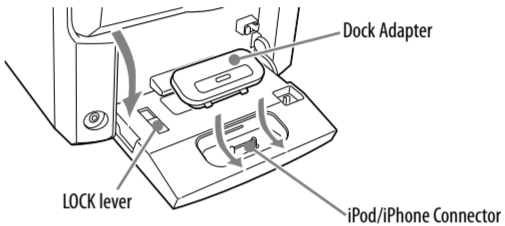

To remove the Dock Adapter, pull it up with your fingernail or a flat object using the slot inside the adapter.

- **Notes**
  - Keep the LOCK lever in the HOLD position while the iPod/iPhone is in use.
  - The Dock Adapter is not supplied with the system. Use the adapter supplied with your iPod when using an iPod model. When using an iPhone, iPhone 3G or iPhone 3GS, purchase a compatible Dock Adapter from Apple Inc. For details on the Dock Adapters, refer to the instructions supplied with the Dock Adapters.

## To adjust the volume

Press VOLUME +/- (or turn the VOLUME control on the unit) [1].

## To set the clock

Use buttons on the remote to set the clock.

- Press I/O (on/standby) [1] to turn on the system.
- Press TIMER MENU [21] to select the clock set mode. If "PLAY SET" flashes, press ▲/▼ [25] repeatedly to select "CLOCK," and then press ○ (enter) [22].
- Press ▲/▼ [25] repeatedly to set the hour, and then press ○ [22].
- Use the same procedure to set the minutes.

**Note**  
The clock settings are lost when you disconnect the power cord or if a power failure occurs.

**To display the clock when the system is off**  
Press DISPLAY [30]. The clock is displayed for about 8 seconds.

## WARNING

**To reduce the risk of fire or electric shock, do not expose this apparatus to rain or moisture.**

To reduce the risk of fire, do not cover the ventilation opening of the apparatus with newspapers, tablecloths, curtains, etc. Do not place the naked flame sources such as lighted candles on the apparatus.

To reduce the risk of fire or electric shock, do not expose this apparatus to dripping or splashing, and do not place objects filled with liquids, such as vases, on the apparatus. Do not install the appliance in a confined space, such as a bookcase or built-in cabinet.

As the main plug is used to disconnect the unit from the mains, connect the unit to an easily accessible AC outlet. Should you notice an abnormality in the unit, disconnect the main plug from the AC outlet immediately.

Do not expose batteries or apparatus with battery-installed to excessive heat such as sunshine, fire or the like.

The unit is not disconnected from the mains as long as it is connected to the AC outlet, even if the unit itself has been turned off.

## CAUTION

The use of optical instruments with this product will increase eye hazard.

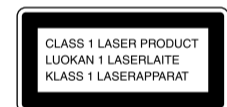

This appliance is classified as a CLASS 1 LASER product. This marking is located on the rear exterior.

## Notice for the customers in the U.S.A. and Canada

This symbol is intended to alert the user to the presence of uninsulated "dangerous voltage" within the product's enclosure that may be of sufficient magnitude to constitute a risk of electric shock to persons.

This symbol is intended to alert the user to the presence of important operating and maintenance (servicing) instructions in the literature accompanying the appliance.

## Owner's Record

The model and serial numbers are located on the rear of the unit. Record these numbers in the space provided below. Refer to them whenever you call upon your Sony dealer regarding this product.

Model No. \_\_\_\_\_  
Serial No. \_\_\_\_\_

## Important Safety Instructions

- 1) Read these instructions.
- 2) Keep these instructions.
- 3) Heed all warnings.
- 4) Follow all instructions.
- 5) Do not use this apparatus near water.
- 6) Clean only with dry cloth.
- 7) Do not block any ventilation openings. Install in accordance with the manufacturer's instructions.
- 8) Do not install near any heat sources such as radiators, heat registers, stoves, or other apparatus (including amplifiers) that produce heat.
- 9) Do not defeat the safety purpose of the polarized or grounding-type plug. A polarized plug has two blades with one wider than the other. A grounding type plug has two blades and a third grounding prong. The wide blade or the third prong are provided for your safety. If the provided plug does not fit into your outlet, consult an electrician for replacement of the obsolete outlet.
- 10) Protect the power cord from being walked on or pinched particularly at plugs, convenience receptacles, and the point where they exit from the apparatus.
- 11) Only use attachments/accessories specified by the manufacturer.
- 12) Use only with the cart, stand, tripod, bracket, or table specified by the manufacturer, or sold with the apparatus. When a cart is used, use caution when moving the cart/apparatus combination to avoid injury from tip-over.
- 13) Unplug this apparatus during lightning storms or when unused for long periods of time.
- 14) Refer all servicing to qualified service personnel. Servicing is required when the apparatus has been damaged in any way, such as power-supply cord or plug is damaged, liquid has been spilled or objects have fallen into the apparatus, the apparatus has been exposed to rain or moisture, does not operate normally, or has been dropped.

**The following FCC statement applies only to the version of this model manufactured for sale in the U.S.A. Other versions may not comply with FCC technical regulations.**

## NOTE:

This equipment has been tested and found to comply with the limits for a Class B digital device, pursuant to Part 15 of the FCC Rules. These limits are designed to provide reasonable protection against harmful interference in a residential installation. This equipment generates, uses, and can radiate radio frequency energy and, if not installed and used in accordance with the instructions, may cause harmful interference to radio communications. However, there is no guarantee that interference will not occur in a particular installation. If this equipment does cause harmful interference to radio or television reception, which can be determined by turning the equipment off and on, the user is encouraged to try to correct the interference by one or more of the following measures:

- Reorient or relocate the receiving antenna.
- Increase the separation between the equipment and receiver.
- Connect the equipment into an outlet on a circuit different from that to which the receiver is connected.
- Consult the dealer or an experienced radio/TV technician for help.

## CAUTION

You are cautioned that any changes or modifications not expressly approved in this manual could void your authority to operate this equipment.

